

Dream granite Cabinets



**ANTIQUÉ WHITE
A-7**



3/4" Solid wood cabinets, face-frame fastened together with mortise and tenon glued joinery.

3/4" Solid raised panel doors fastened together with glued wood joinery

5/8" Solid Maple drawers attached to an under mount drawer glide.

1/2" Finished plywood cabinet sides and toe kick with wood hang rails. 5/8" plywood adjustable

Shelves.

Finished clear natural plywood back and bottom.

stain finishing process ensuring long life, consistency and durability of wood.

Under mount drawer glides for smooth and quiet operation and soft closing

Fully concealed, self closing metal hinges for easy operation.

Exclusive fastening clip assembly system.

Shipped unassembled in individual boxes on a pallet to keep the shipping costs to a minimum

BASE WASTE BASKET - 1 DRAWER, 1 DOOR

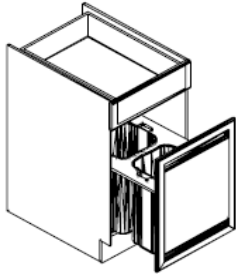

Item Code	W" X D" X H"	B2	H6	D3	10	M01	A7	K8	J5
BWBK18-2	18 X 24 X 34.5	•	•	•	•	•	•	•	•

Note: K10, M01, K8, J5, AND A7 has 1 Pre-cut hole, does not come with basket :::: B2, H6, D3 has 2 Pre-cut Hole

LAZY SUSAN CABINET- LAZY SUSAN, FOLDING DOORS (Includes Wood Lazy Susan)

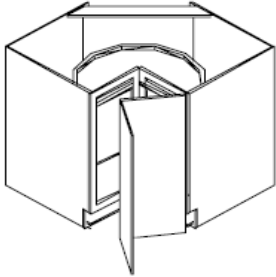

Item Code	W" X D" X H"	B2	H6	D3	10	M01	A7	K8	J5
LS3612	36 X 24 X 34.5	•	•	•	•	•	•	•	•

CORNER LAZY SUSAN CABINET- 1 DOOR

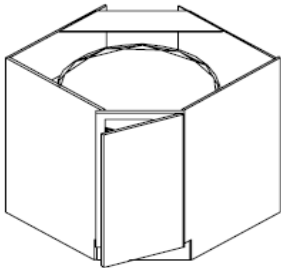

Item Code	W" X D" X H"	B2	H6	D3	10	M01	A7	K8	J5
CBD36	36 X 24 X 34.5	•	•	•	•	•	•	•	•

Note: This can also be used as CSB36, just leave out the Lazy Susan

CORNER SINK CABINET- 1 DOOR, 1 SHELF

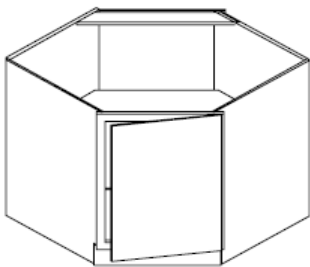

Item Code	W" X D" X H"	B2	H6	D3	10	M01	A7	K8	J5
CSB36	36 X 24 X 34.5	•	•	•	•	•	•	•	•

BLIND CORNER CABINET- 1 DRAWER, 1 DOOR, 1 SHELF

Item Code	W" X D" X H"	B2	H6	D3	10	M01	A7	K8	J5
BBC42	42 X 24 X 34.5	•	•	•	•	•	•	•	•

**** PULL 3" FROM WALL. 45" CLEARANCE NEEDED- RECOMMENDED

**** LEFT / RIGHT [Picture shown BBC42R, opening on right)

SPICE PULL OUT - 1 FULL HEIGHT DOOR

	Item Code	W" X D" X H"	B2	H6	D3	10M01	A7	K8	J5
	SP09	09 X 24 X 34.5	•	•	•	•	•	•	•

SPICE DRAWER- 5 SPICE DRAWER

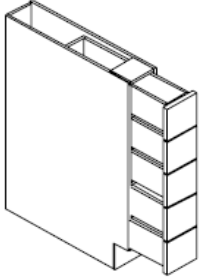

	Item Code	W" X D" X H"	B2	H6	D3	10M01	A7	K8	J5
	BWRC6	06 X 24 X 34.5	•	•	•	•	•	•	•

BASE END CORNER CABINET - 2 DOOR 1 SHELF 2 DUMMY DOOR

	Item Code	W" X D" X H"	B2	H6	D3	10M01	A7	K8	J5
	BEC24	24 X 24 X 34.5	•	•	•	•	•	•	•

Note: Dummy drawer panel on top.

BASE END SHELF - 3 SHELVES

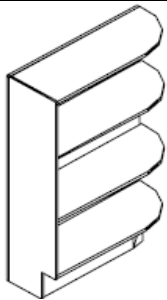

	Item Code	W" X D" X H"	B2	H6	D3	10M01	A7	K8	J5
	BES09	09 X 24 X 34.5	•	•	•	•	•	•	•

Note: Use this for Right / Left

PENINSULA BASE CABINET- 2 DOOR 2 DRAWER

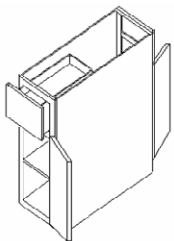

	Item Code	W" X D" X H"	B2	H6	D3	10M01	A7	K8	J5
	PB18	18 X 33 X 34.5				•	•		

Note: Can be open from both side.

WALL CABINET- 2 DOOR 2 SHELF

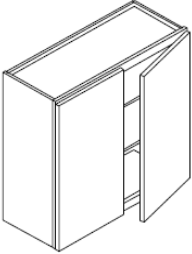
	Item Code	W" X D" X H"	B2	H6	D3	10	M01	A7	K8	J5
	W2430	24 X 12 X 30	●	●	●	●	●	●	●	●
	W2730	27 X 12 X 30	●	●	●	●	●	●	●	●
	W3030	30 X 12 X 30	●	●	●	●	●	●	●	●
	W3330	33 X 12 X 30	●	●	●	●	●	●	●	●
	W3630	36 X 12 X 30	●	●	●	●	●	●	●	●

WALL CABINET- 2 DOOR 2 SHELF

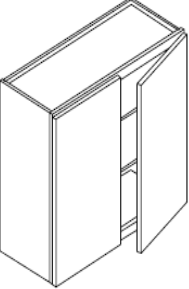
	Item Code	W" X D" X H"	B2	H6	D3	10	M01	A7	K8	J5
	W2436	24 X 12 X 36	●	●	●	●	●	●	●	●
	W2736	27 X 12 X 36	●	●	●	●	●	●	●	●
	W3036	30 X 12 X 36	●	●	●	●	●	●	●	●
	W3336	33 X 12 X 36	●	●	●	●	●	●	●	●
	W3636	36 X 12 X 36	●	●	●	●	●	●	●	●

WALL CABINET- 1 DOOR 3 SHELF

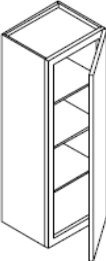
	Item Code	W" X D" X H"	B2	H6	D3	10	M01	A7	K8	J5
	W0942	09 X 12 X 42	●	●	●	●	●	●	●	●
	W1242	12 X 12 X 42	●	●	●	●	●	●	●	●
	W1542	15 X 12 X 42	●	●	●	●	●	●	●	●
	W1842	18 X 12 X 42	●	●	●	●	●	●	●	●
	W2142	21 X 12 X 42	●	●	●	●	●	●	●	●

WALL CABINET- 2 DOOR 3 SHELF

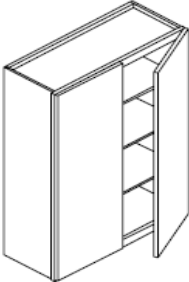
	Item Code	W" X D" X H"	B2	H6	D3	10	M01	A7	K8	J5
	W2442	24 X 12 X 42	●	●	●	●	●	●	●	●
	W2742	27 X 12 X 42	●	●	●	●	●	●	●	●
	W3042	30 X 12 X 42	●	●	●	●	●	●	●	●
	W3342	33 X 12 X 42	●	●	●	●	●	●	●	●
	W3642	36 X 12 X 42	●	●	●	●	●	●	●	●

WALL GLASS CABINET- 1 GLASS DOOR FRAME :::

Item Code	W" X D" X H"	B2	H6	D3	10	M01	A7	K8	J5
WM153615H	15 x 15 x 36	●	●	●	●	NA	NA	NA	NA
WM1530H	15 x 12 x 30	●	●	NA	●	●	●	●	●
WM1830H	18 x 12 x 30	●	●	●	●	●	●	●	●
WM1536H	15 x 12 x 36	●	●	NA	●	●	●	●	●
WM1836H	18 x 12 x 36	●	●	●	●	●	●	●	●

***Glass inserts & Glass Shelves sold separately**

WALL GLASS CABINET- 2 GLASS DOOR FRAME:::

	Item Code	W" X D" X H"	B2	H6	D3	10M01	A7	K8	J5
	WM2430H	24 x 12 x 30	●	●	●	●	●	●	●
	WM2730H	27 x 12 x 30	●	●	●	●	●	●	●
	WM3030H	30 x 12 x 30	●	●	●	●	●	●	●
	WM2436H	24 x 12 x 36	●	●	●	●	●	●	●
	WM2736H	27 x 12 x 36	●	●	●	●	●	●	●
	WM3036H	30 x 12 x 36	●	●	●	●	●	●	●

*

WALL GLASS CABINET- 2 GLASS DOOR FRAME:::

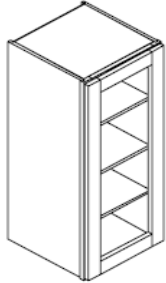

	Item Code	W" X D" X H"	B2	H6	D3	10M01	A7	K8	J5
	WM154215H	15 x 15 x 42	●	●	●	●	NA	NA	NA
	WM1542H	15 x 12 x 42	●	●	NA	●	●	●	●
	WM1842H	18 x 12 x 42	●	●	●	●	●	●	●

*Glass inserts & Glass Shelves sold separately

WALL GLASS CABINET- 2 GLASS DOOR FRAME :::

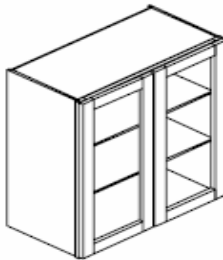

	Item Code	W" X D" X H"	B2	H6	D3	10M01	A7	K8	J5
	WM2442H	24 x 12 x 42	●	●	●	●	●	●	●
	WM2742H	27 x 12 x 42	●	●	●	●	●	●	●
	WM3042H	30 x 12 x 42	●	●	●	●	●	●	●

*Glass inserts & Glass Shelves sold separately

WALL GLASS CABINET- 1 GLASS DOOR FRAME ::: w/ Match Interior

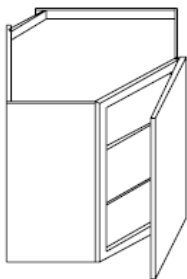

	Item Code	W" X D" X H"	B2	H6	D3	10M01	A7	K8	J5
	WMDC2430H	24 x 24 x 30	●	●	●	●	●	●	●
	WMDC2436H	24 x 24 x 36	●	●	●	●	●	●	●
	WMDC273615H	27 x 27 x 36	●	●	●	●	●	●	●

*Glass inserts & Glass Shelves sold separately

WALL GLASS CABINET- 1 GLASS DOOR FRAME ::: w/ Match Interior

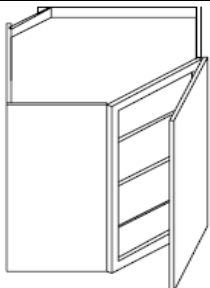

	Item Code	W" X D" X H"	B2	H6	D3	10M01	A7	K8	J5
	WMDC2442H	24 x 24 x 42	●	●	●	●	●	●	●
	WMDC274215H	27 x 27 x 42	●	●	●	●	●	●	●

*Glass inserts & Glass Shelves sold separately

WALL GLASS RACK

	Item Code	W" X D" X H"	B2	H6	D3	10	M01	A7	K8	J5
	30GR	30 x 12 x 3	•	•	•	•	•	•	•	•
	36GR	36 x 12 x 3	•	•	•	•	•	•	•	•

WALL MICROWAVE CABINET

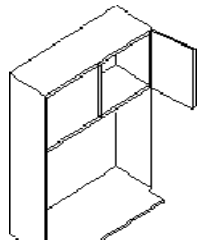

	Item Code	W" X D" X H"	B2	H6	D3	10	M01	A7	K8	J5
	WBL2730	27 x 12 x 30	•	•	•	•	•	•	•	•
	WBL2736	27 x 12 x 36	•	•	•	•	•	•	•	•
	WBL2742	27 x 12 x 42	•	•	•	•	•	•	•	•

***NOTE: FOR B2/H6/D3 MICROWAVE PANEL SOLD SEPERATELY code: GB**

APPLIANCE GARAGE

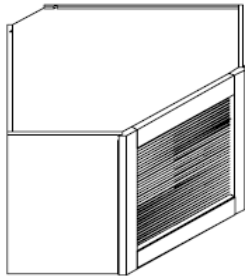

	Item Code	W" X D" X H"	B2	H6	D3	10	M01	A7	K8	J5
	AG2418	24 x 24 x 18	•	•	•	•	•	•	•	•
	AG2718	27 x 27 x 18	•	•	•	•	•	•	•	•

WALL SPICE DRAWER

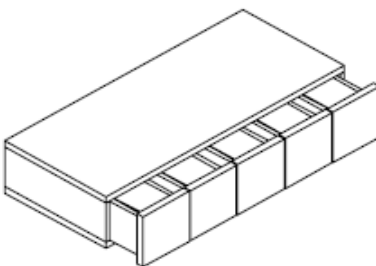

	Item Code	W" X D" X H"	B2	H6	D3	10	M01	A7	K8	J5
	WWRC-6	30 x 12 x 06	•	•	•	•	•	•	•	•

TALL PANTRY - FOR K10, M01, J5, K8, A7

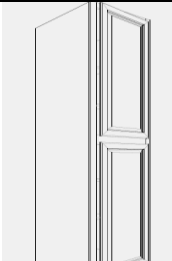

	Item Code	W" X D" X H"	B2	H6	D3	10	M01	A7	K8	J5
	WP188427	18 x 27 x 84				•	•	•	•	•
	WP189027	18 x 27 x 90				•	•	•	•	•
	WP189627	18 x 27 x 96				•	•	•	•	•

*** 3 ROLL OUT TRAY ON THE BOTTOM, SHELVES ON TOP**

TALL PANTRY - FOR K10, M01 ONLY

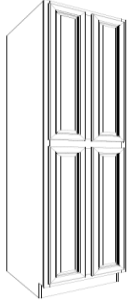

Item Code	W" X D" X H"				10M01	A7	K8	J5
WP248427	24 x 27 x 84				•	•	•	•
WP249027	24 x 27 x 90				•	•	•	•
WP249627	24 x 27 x 96				•	•	•	•
WP308427	30 x 27 x 84				•	•	•	•
WP309027	30 x 27 x 90				•	•	•	•
WP309627	30 x 27 x 96				•	•	•	•

*** 3 ROLL OUT TRAY ON THE BOTTOM, SHELVES ON TOP**

TALL PANTRY - FOR B2, D3, H6,

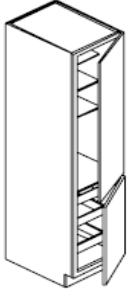

Item Code	W" X D" X H"	B2	H6	D3				
WP188427	18 x 27 x 84	•	•	•				
WP189027	18 x 27 x 90	•	•	•				
WP189627	18 x 27 x 96	•	•	•				

*** 3 ROLL OUT TRAY ON THE BOTTOM, SHELVES ON TOP**

TALL PANTRY - FOR B2, D3, H6, H9

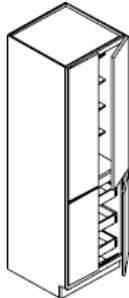

Item Code	W" X D" X H"	B2	H6	D3				
WP248427	24 x 27 x 84	•	•	•				
WP249027	24 x 27 x 90	•	•	•				
WP249627	24 x 27 x 96	•	•	•				
WP308427	30 x 27 x 84	•	•	•				
WP309027	30 x 27 x 90	•	•	•				
WP309627	30 x 27 x 96	•	•	•				

*** 3 ROLL OUT TRAY ON THE BOTTOM, SHELVES ON TOP**

SINGLE OVEN CABINET :: 2 Drawers, 2 Doors

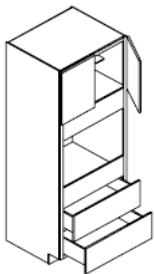

Item Code	W" X D" X H"	B2	H6	D3	10M01	A7	K8	J5
OC309027	30 x 27 x 90	•	•	•	•	•	•	•
OC309627	30 x 27 x 96	•	•	•	•	•	•	•
OC339027	33 x 27 x 90	•	•	•	NA	NA	NA	NA
OC339627	33 x 27 x 96	•	•	•	NA	NA	NA	NA

******* OPENING WIDTH 27" on 30" Oven :: 30" on 33" Oven ::: Max Height 44" on B2/H6/D3 ::: Max Height 50" on K10/M01/A7/K8/J5/E9**

DOUBLE OVEN CABINET

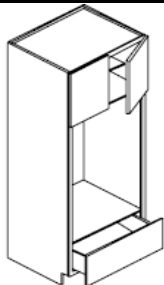

Item Code	W" X D" X H"	B2	H6	D3	10M01	A7	K8	J5
OC309027WO	30 x 27 x 90	•	•	•	•	•	•	•
OC309627WO	30 x 27 x 96	•	•	•	•	•	•	•
OC339027WO	33 x 27 x 90	•	•	•	NA	NA	NA	NA
OC339627WO	33 x 27 x 96	•	•	•	NA	NA	NA	NA

******* OPENING WIDTH 27" on 30" Oven :: 30" on 33" Oven ::: Max Height 59" on B2/H6/D3 ::: Max Height 59 1/2" on K10/M01/A7/K8/J5/E9**

FLUTED PLINTH BLOCK

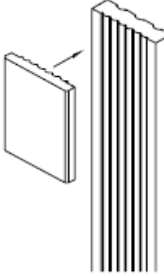
	Item Code	W" X D" X H"	B2	H6	D3	10M01	A7	K8	J5
	BB 3*3	3 x 1/2 x 4	•	•	•	•	•	•	•

FLUTED/BEADED FILLER

	Item Code	W" X D" X H"	B2	H6	D3	10M01	A7	K8	J5
	PCVFF3	3 x 3/4 x 96	•	•	•	•	•	•	•

TALL FILLER

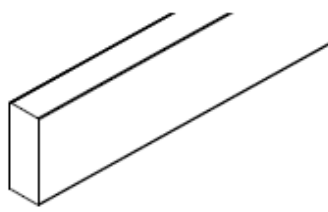
	Item Code	W" X D" X H"	B2	H6	D3	10M01	A7	K8	J5	
	CM34-2	2 x 3/4 x 96	•	•	•	•	•	NA	NA	NA
	CM34-3	3 x 3/4 x 96	•	•	•	•	•	•	•	•

BASE FILLER

	Item Code	W" X D" X H"	B2	H6	D3	10M01	A7	K8	J5
	BF3	3 x 3/4 x 34.5	•	•	•	•	•	•	•
	BF6	6 x 3/4 x 34.5	•	•	•	•	•	•	•

WALL FILLER

	Item Code	W" X D" X H"	B2	H6	D3	10M01	A7	K8	J5
	WF330	3 x 3/4 x 30	•	•	•	•	•	•	•
	WF336	3 x 3/4 x 36	•	•	•	•	•	•	•
	WF342	3 x 3/4 x 42	•	•	•	•	•	•	•
	WF630	6 x 3/4 x 30	•	•	•	•	•	•	•
	WF636	6 x 3/4 x 36	•	•	•	•	•	•	•
	WF642	6 x 3/4 x 42	•	•	•	•	•	•	•
	WF1236	12 x 3/4 x 36	NA	NA	NA	•	•	NA	NA

DISHWASHER PANEL WITH 3" RETURN FILLER

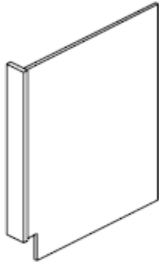

Item Code	W" X D" X H"	B2	H6	D3	10M01	A7	K8	J5
DWR	3 x 24 x 34.5	•	•	•	•	•	•	•

*** WITH 3" RETURN (Can be used both Left & Right)

REFRIGERATOR PANEL WITH 3" RETURN FILLER

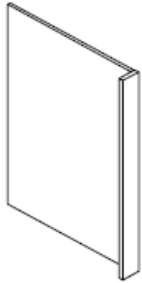

Item Code	W" X D" X H"	B2	H6	D3	10M01	A7	K8	J5
RRP8427		•	•	•	•	•	•	•
RRP9027		•	•	•	•	•	•	•
RRP9627		•	•	•	•	•	•	•

*** WITH 3" RETURN (Can be used both Left & Right)

BASE SKIN PANEL

Item Code	W" X D" X H"	B2	H6	D3	10M01	A7	K8	J5
BP3696 (SHORT GRAIN)	96 x 1/8 x 36	•	•	•	•	•	•	•
BP9636 (LONG GRAIN)	36 x 1/8 x 96	•	•	•	•	•	•	•

FRIEZE VALANCE



Item Code	W" X D" X H"	B2	H6	D3	10M01	A7	K8	J5
V30A	30 x 3/4 x 4	•	•	•	•	•	•	•
V33A	33 x 3/4 x 4	NA	NA	NA	NA	NA	NA	NA
V36A	36 x 3/4 x 4	•	•	•	•	•	•	•
V42A	42 x 3/4 x 4	•	•	•	•	•	•	•
V48A	48 x 3/4 x 4				•	•	•	•
V60A	60 x 3/4 x 4				•	•	•	•

ARCHED VALANCE

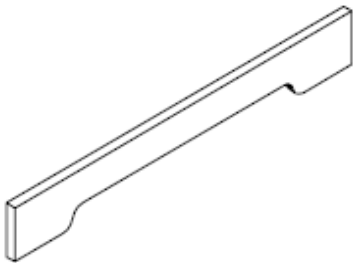

Item Code	W" X D" X H"	B2	H6	D3	10M01	A7	K8	J5
V30B	30 x 3/4 x 4	•	•	•	•	•	•	•
V33B	33 x 3/4 x 4	NA	NA	NA	NA	NA	NA	NA
V36B	36 x 3/4 x 4	•	•	•	•	•	•	•
V42B	42 x 3/4 x 4	•	•	•	•	•	•	•
V48B	48 x 3/4 x 4	•	•	•	•	•	•	•
V60B	60 x 3/4 x 4	•	•	•	•	•	•	•

ROLL OUT TRAY

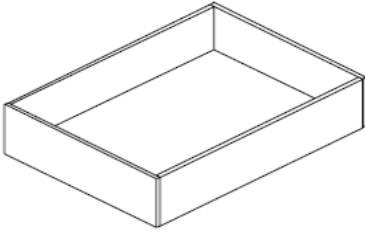

*Comes with Ball Bearing Glide

Item Code	W" X D" X H"	B2	H6	D3	K10	M01	A7	K8	J5
RD18		•	•	•	•	•	•	•	•
RD21		•	•	•	•	•	•	•	•
RD24		•	•	•	•	•	•	•	•
RD30		•	•	•	•	•	•	•	•
RD36		•	•	•	•	•	•	•	•

SPLIT POST



Item Code	W" X D" X H"	B2	H6	D3	K10	M01	A7	K8	J5
RPS18	2 x 3/4 x 18	•	NA	NA	•	•	•	•	•
RPS24	2 x 3/4 x 24	•	NA	NA	•	•	•	•	•
RPS30	2 x 3/4 x 30	•	NA	NA	•	•	•	•	•
RPS36	2 x 3/4 x 36	•	NA	NA	•	•	•	•	•
RPS42	2 x 3/4 x 42	•	NA	NA	•	•	•	•	•

SMALL GRAPE ORNAMENT

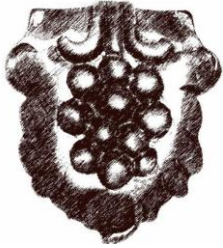

Item Code	W" X D" X H"	B2	H6	D3	K10	M01	A7	K8	J5
SGO	3 x 5/8 x 4	NA	NA	NA	•	•	NA		NA

SMALL LEAF ORNAMENT

Item Code	W" X D" X H"	B2	H6	D3	K10	M01	A7	K8	J5
RGO	3 x 5/8 x 4	NA	NA	NA	NA	NA	•		NA

SMALL GRAPE CORBEL

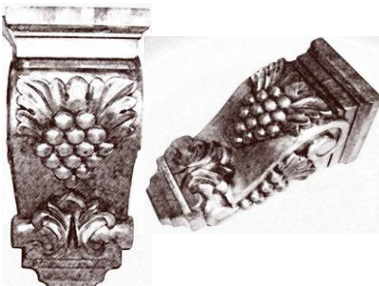

Item Code	W" X D" X H"	B2	H6	D3	K10	M01	A7	K8	J5
GC58	4 1/2 x 5 x 10	NA	NA	NA	•	•	NA		NA

GRAPE ONLAY

	Item Code	W" X D" X H"	B2	H6	D3	10M01	A7	K8	J5
		GRPO	20 x 5/8 x 4 1/2	•	NA	NA	•	•	NA

LEAF ONLAY

	Item Code	W" X D" X H"	B2	H6	D3	10M01	A7	K8	J5
		RRPO	20 x 5/8 x 4 1/2	•	NA	NA	NA	NA	•

DÉCOR

	Item Code	W" X D" X H"	B2	H6	D3	10M01	A7	K8	J5
		ASO	6 x 5/8 x 6				•	•	NA
	RSO	6 x 5/8 x 6				NA	NA	•	NA

TALL GRAPE ONLAY

	Item Code	W" X D" X H"	B2	H6	D3	10M01	A7	K8	J5
		OLC318	3 x 3 x 18	NA	NA	NA	•	•	NA
	RLC318	3 x 3 x 18	NA	NA	NA	NA	NA	•	•

EX-LARGE CORBEL

	Item Code	W" X D" X H"	B2	H6	D3	10M01	A7	K8	J5
		CB34 1/2	6 1/4 x 5 1/4 x 34 1/2	NA	NA	NA	•	NA	NA

